

# 湛江千护宝生物有限公司生态养殖基地养殖水域界至图

2325.830-37406.780

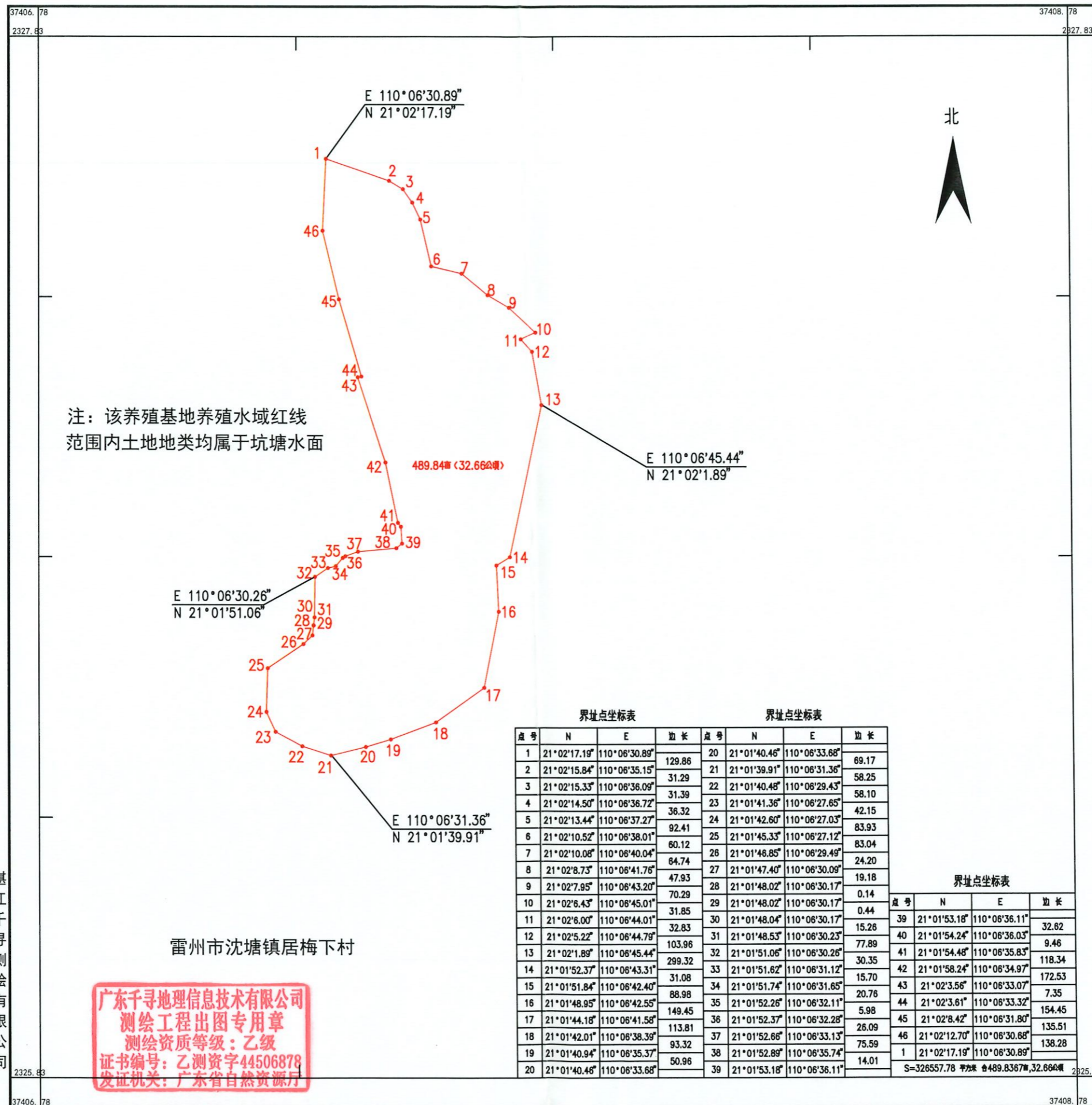

注：该养殖基地养殖水域红线范围内土地地类均属于坑塘水面

E 110°06'30.26"  
N 21°01'51.06"

489.84m (32.66公顷)

E 110°06'45.44"  
N 21°02'1.89"

E 110°06'31.36"  
N 21°01'39.91"

雷州市沈塘镇居梅下村

广东千寻地理信息技术有限公司  
测绘工程出图专用章  
测绘资质等级：乙级  
证书编号：乙测资字44506878  
发证机关：广东省自然资源厅

界址点坐标表

点号	N	E	边长	点号	N	E	边长
1	21°02'17.19"	110°06'30.89"	129.86	20	21°01'40.46"	110°06'33.68"	69.17
2	21°02'15.84"	110°06'35.15"	31.29	21	21°01'39.91"	110°06'31.36"	58.25
3	21°02'15.33"	110°06'36.09"	31.39	22	21°01'40.48"	110°06'29.43"	58.10
4	21°02'14.50"	110°06'36.72"	36.32	23	21°01'41.36"	110°06'27.65"	42.15
5	21°02'13.44"	110°06'37.27"	92.41	24	21°01'42.60"	110°06'27.03"	83.93
6	21°02'10.52"	110°06'38.01"	60.12	25	21°01'45.33"	110°06'27.12"	83.04
7	21°02'10.08"	110°06'40.04"	64.74	26	21°01'46.85"	110°06'29.49"	24.20
8	21°02'8.73"	110°06'41.76"	47.93	27	21°01'47.40"	110°06'30.09"	19.18
9	21°02'7.95"	110°06'43.20"	70.29	28	21°01'48.02"	110°06'30.17"	0.14
10	21°02'6.43"	110°06'45.01"	31.85	29	21°01'48.02"	110°06'30.17"	0.44
11	21°02'6.00"	110°06'44.01"	32.83	30	21°01'48.04"	110°06'30.17"	15.28
12	21°02'5.22"	110°06'44.78"	103.96	31	21°01'48.53"	110°06'30.23"	77.89
13	21°02'1.89"	110°06'45.44"	299.32	32	21°01'51.06"	110°06'30.26"	30.35
14	21°01'52.37"	110°06'43.31"	31.08	33	21°01'51.62"	110°06'31.12"	15.70
15	21°01'51.84"	110°06'42.40"	88.98	34	21°01'51.74"	110°06'31.65"	20.76
16	21°01'48.95"	110°06'42.55"	149.45	35	21°01'52.26"	110°06'32.11"	5.98
17	21°01'44.18"	110°06'41.58"	113.81	36	21°01'52.37"	110°06'32.28"	26.09
18	21°01'42.01"	110°06'38.39"	93.32	37	21°01'52.66"	110°06'33.13"	75.59
19	21°01'40.94"	110°06'35.37"	50.96	38	21°01'52.89"	110°06'35.74"	14.01
20	21°01'40.46"	110°06'33.68"		39	21°01'53.18"	110°06'36.11"	

界址点坐标表

点号	N	E	边长
39	21°01'53.18"	110°06'36.11"	32.62
40	21°01'54.24"	110°06'36.03"	9.46
41	21°01'54.48"	110°06'35.83"	118.34
42	21°01'58.24"	110°06'34.97"	172.53
43	21°02'3.56"	110°06'33.07"	7.35
44	21°02'3.61"	110°06'33.32"	154.45
45	21°02'8.42"	110°06'31.80"	135.51
46	21°02'12.70"	110°06'30.68"	138.28
1	21°02'17.19"	110°06'30.89"	

界址点坐标表

点号	N	E	边长
39	21°01'53.18"	110°06'36.11"	32.62
40	21°01'54.24"	110°06'36.03"	9.46
41	21°01'54.48"	110°06'35.83"	118.34
42	21°01'58.24"	110°06'34.97"	172.53
43	21°02'3.56"	110°06'33.07"	7.35
44	21°02'3.61"	110°06'33.32"	154.45
45	21°02'8.42"	110°06'31.80"	135.51
46	21°02'12.70"	110°06'30.68"	138.28
1	21°02'17.19"	110°06'30.89"	

S=326557.78 平方米 489.8367亩, 32.66公顷

湛江千寻测绘有限公司

2000国家大地坐标系，中央子午线为111°。  
GB/T 20257.1-2017国家基本比例尺地图图式  
第1部分：1:500 1:1000 1:2000地形图图式  
2021年12月数字化测绘。

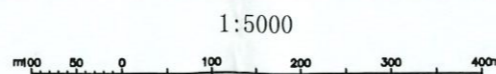

1:5000

附注：测绘：张升  
制图：张升  
审核：李超